



RDL®

High Performance Audio Products. Made in America.

Model D SERIES-NLC1R Network Remote Control with LEDs



- Rotary Encoder Remote Control with LED Rotary String Display
- Knob Rotation Adjusts Audio Volume Up or Down
- Attenuation Adjustment in 1 dB Steps From 0 to 64 dB
- Each D*-NLC1R Can Control One or Multiple RDL Products
- Multiple D*-NLC1Rs Can Control One or More RDL Products
- Programmable Knob Action Acceleration
- Momentary Knob Push to Mute/Unmute with LED Indication
- Compatible with D-RN, DD-RN and Other RDL Products*
- Sends Level Commands to Network Devices that Adjust Audio Levels*
- Displays Audio Attenuation Level Reported by a Network Audio Device*
- PoE Powered
- Available in Black (DB-NLC1R), White (D-NLC1R) and Stainless Steel (DS-NLC1R)

APPLICATION: The D SERIES-NLC1R is a rotary remote control that provides volume control and muting at single or multiple user locations. The -NLC1R connects to a local network that may include compatible RDL audio and control modules as well as Dante devices from RDL and other manufacturers. The unit provides level indication on a rotary LED string display. If multiple -NLC1R units are assigned to control the same RDL product or group of products, the -NLC1R units all remain active with tracking volume displays. The -NLC1R may also be used as an auxiliary volume control in a zone where the primary control is an RDL D*-NMC1R. Network bandwidth typically supports up to 4 of these remote controls per zone.

The -NLC1R display shows the relative level using LEDs in a circular pattern. The level is adjusted by the user using the rotary encoder knob with mechanical detents. The knob rotation includes pre-programmed acceleration when the knob is turned quickly, such as to reduce an unexpectedly high level or feedback. The installer can refine the acceleration during the unit setup in RDL CONSOLE, RDL's configuration software for networked endpoints and controls. A user can mute the audio by momentarily pushing the knob. The muted condition is shown on the display, as well as on the display of other -NLC1R remote controls that are set to control the volume of the same device. While muted, the next momentary knob push will unmute the audio at its prior volume setting. If, instead, the user rotates the knob clockwise, the volume will ramp up, from fully "off", according to the rotation of the knob.

After 30 seconds of adjustment inactivity, the -NLC1R display is dimmed. It returns to normal intensity upon any knob activity.

The field-upgradable -NLC1R provides a wide range of remote-control capabilities in an intuitive and attractive interface that is simple to operate.

**Note: Network audio flows do not pass through nor are directly adjusted by the D-NLC1R. The D-NLC1R is a remote control that remotely adjusts the audio level in a compatible network device that handles audio.*



RDL[®]

High Performance Audio Products. Made in America.

Model D SERIES-NLC1R Network Remote Control with LEDs

Installation/Operation



Declaration of Conformity available from rdlnet.com.
Sole EMC specifications provided on product package.
Specifications are subject to change without notice.

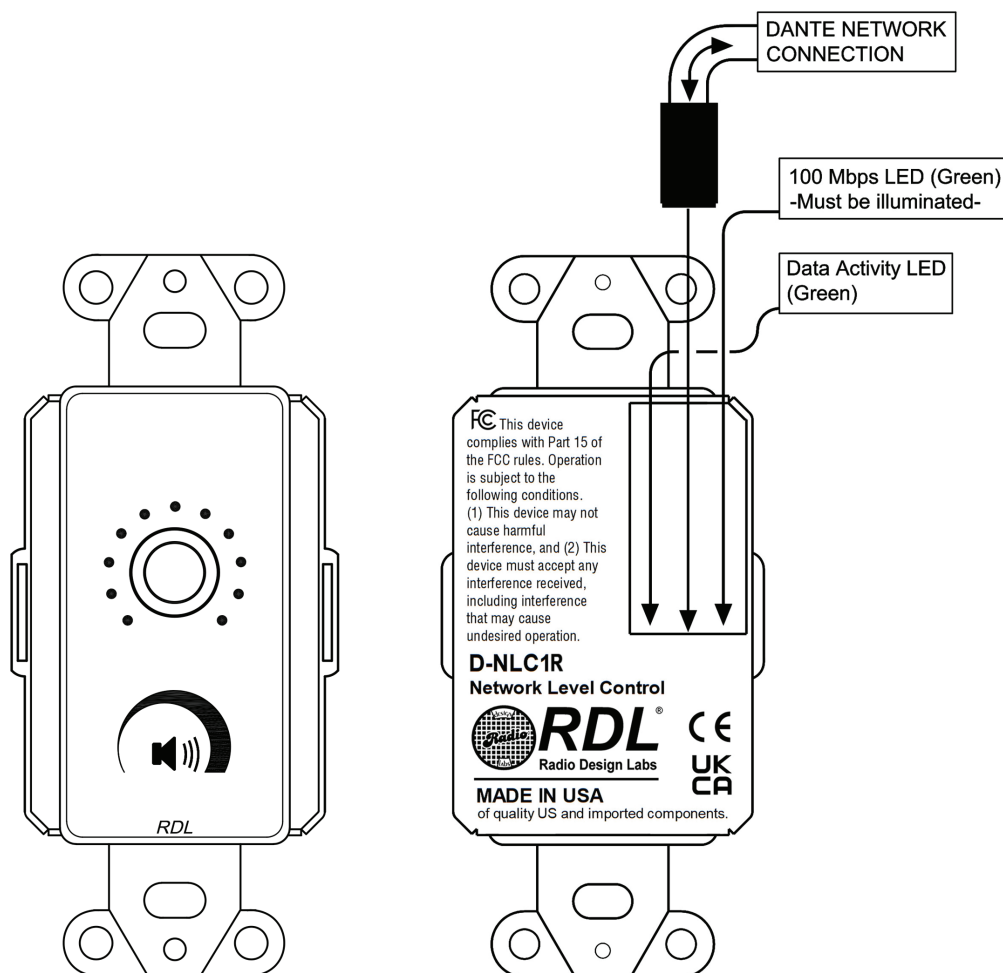

TYPICAL PERFORMANCE

Network Connector:	RJ45 with LED indicators
Transmission Rate:	100 Mbps
Indicators (12):	Ethernet Link and Speed (2, rear panel); Level (10, front panel)
Rotary Control:	Knob push: Mute/Unmute; Knob rotation: Level Up/Down
Ambient Operating Environment:	0° C to 50°
Power Requirement:	PoE Class 0, IEEE 802.3af
Mounting:	Mounts in standard US electrical box; cover plate available separately
Dimensions:	1.8" (4.57 cm) W; 4.11" (10.44 cm) H; 1.61" (4.09 cm) D
Package Type:	Cardboard Box
Package Dimensions:	2.25 x 4.3 x 4.9 in.
Shipping Weight:	0.51 lbs.
WEEE weight:	0.37 lbs.

Radio Design Labs Technical Support Centers

U.S.A. (800) 933-1780, (928) 778-3554 - Europe [NH Amsterdam-Duivendrecht] (++31) 20-6238 983